

Safety on Drill Presses

UNGUARDED DRILL PRESS

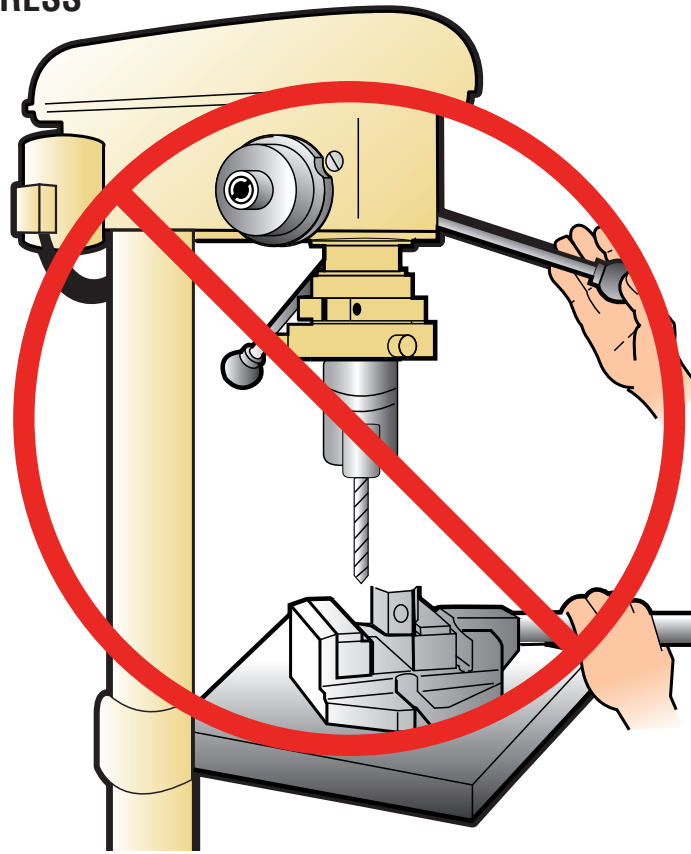

SAFEGUARDED DRILL PRESS

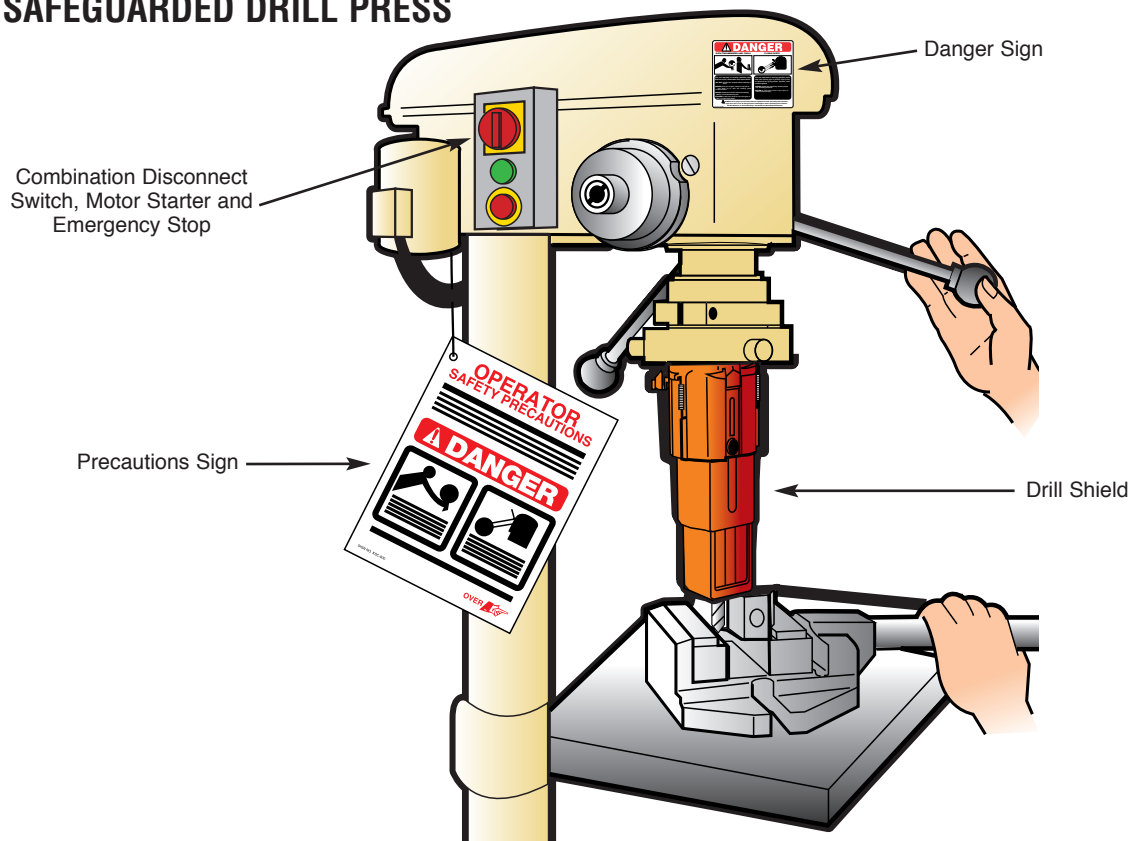



**Electrically Interlocked
Heavy-Duty Drill
Press Shields
(Pages 10-11)**



**Safety Chip Shields
(Page 18)**



**Heavy-Duty Aluminum
Drill Press Shields
(Page 19)**



**Telescoping Drill
Press Shields
(Pages 20-21)**



**Rigid-Arm Magnetic-
Base Shields
(Page 47)**



**Flexible Copolymer
Lock-Arm Shields
(Pages 51-54)**



**Flexible Spring-Steel
Arm Shields
(Pages 55-58)**



**Universal Ball & Socket
Shields
(Pages 48-50)**



**On/Off Magnetic-
Base Shields
(Pages 59-60)**



**Adjustable Slide
Shields
(Page 46)**



**Bushings
(Page 20)**



**Self-Ejecting Drill
Press Chuck Keys
(Page 21)**



**Sensing Saf-Start®
(Page 65)**



**Disconnect Switches, Motor
Starters, & Accessories
(Pages 63-69)**

SAFETY CHIP SHIELDS

These sturdy safety chip shields provide protection from flying chips, coolant, and rotating parts. They are usually applied to small drill presses, milling machines, etc., and can be magnetically or permanently mounted.

The shield can be attached to any ferrous surface on the machine by an 80-lb pull, 3¹/₄" diameter magnetic base. If a ferrous surface is not available, a 3¹/₄" x 5¹/₄" mounting plate is also furnished with each shield.

The impact-resistant, 3³/₁₆"-thick clear polycarbonate shield provides visibility to the point of operation. It adjusts and locks in any vertical position.

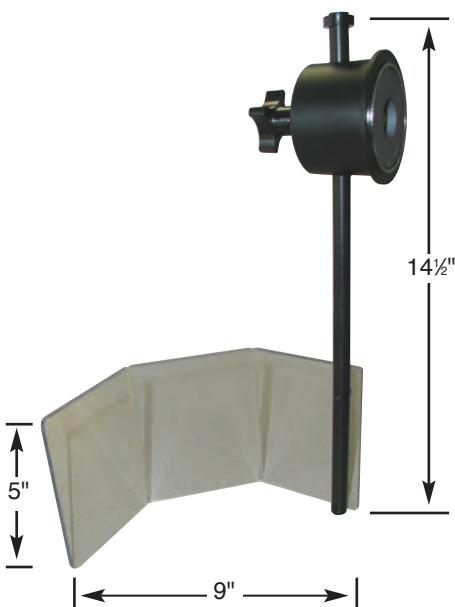

Ordering Information

Part No.	Description
KYL-001	5" x 9" Shield With 1/2" Diameter Black PVC Arm 14 1/2" High
KYM-001	5" x 9" Replacement Shield Only

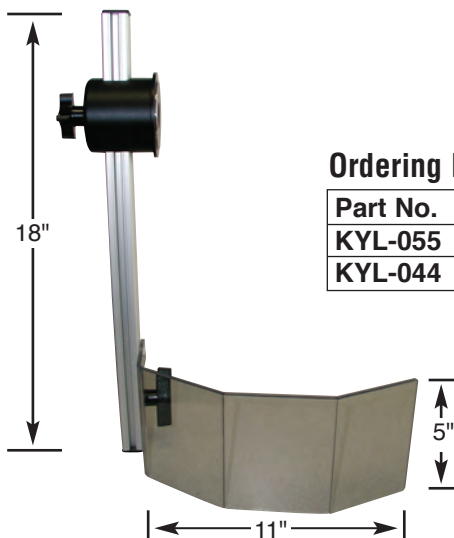

Ordering Information

Part No.	Description
KYL-055	5" x 11" Shield With 1" Square Extruded Aluminum Arm 18" High
KYL-044	5" x 11" Replacement Shield Only



3³/₄" x 5¹/₄" Mounting Plate Furnished With Each Type of Shield For Mounting to a Nonferrous Surface

HEAVY-DUTY ALUMINUM DRILL PRESS SHIELDS

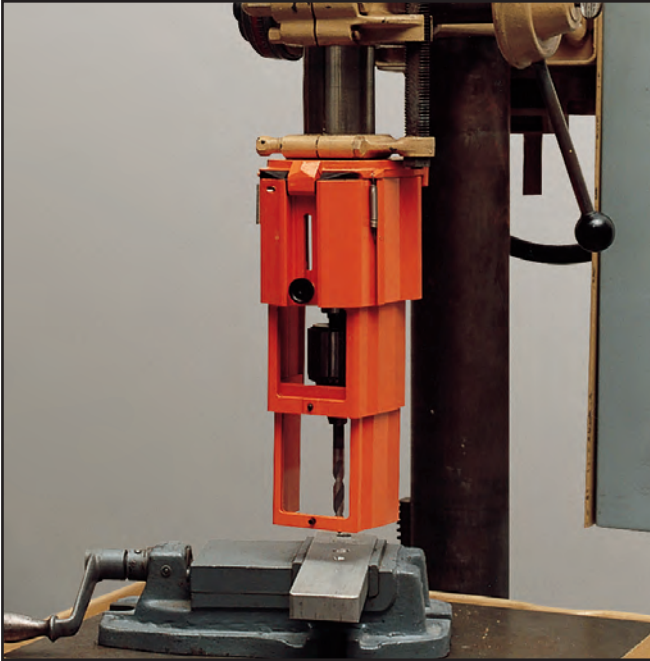

3-tier shield shown in machining position.

These cast-aluminum drill press shields are furnished with a standard 1³/₄" bore. The user can bore this shield to a size up to 3¹/₂" for attaching to the quill of a machine.

This shield is available in 2-tier or 3-tier models which provides 3" to 6" travel of the drill press.

The top of the holder attaches to the quill of the drill press. The shields are open in the back. The bottom section has a clear panel for visibility.

For changing chucks or drill bits, the 2- or 3-tier section can be swung forward and upward out of the way. Also available are shields with a side hinge that swing to the left side.

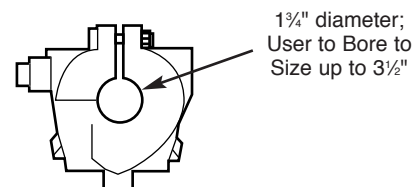

Top view of holder.



Front hinge shield shown open for tool change.

Ordering Information

Part No.	Description
DZS-001	3-Tier Front Hinge 4 ¹ / ₂ " Min; 10 ¹ / ₂ " Max; 6" Stroke; Max Chuck Diameter 2 ¹ / ₂ "
DZS-003	2-Tier Front Hinge 4 ⁵ / ₁₆ " Min; 7" Max; 2 ¹ / ₁₆ " Stroke; Max Chuck Diameter 2 ³ / ₄ "
DZS-004	2-Tier Front Hinge 6" Min; 10 ¹ / ₂ " Max; 4 ¹ / ₂ " Stroke; Max Chuck Diameter 2 ³ / ₄ "
DZS-005	2-Tier Side Hinge 6" Min; 10 ¹ / ₂ " Max; 4 ¹ / ₂ " Stroke; Max Chuck Diameter 2 ³ / ₄ "
DZS-006	3-Tier Side Hinge 4 ¹ / ₂ " Min; 10 ¹ / ₂ " Max; 6" Stroke; Max Chuck Diameter 2 ¹ / ₂ "
DZS-002	Replacement Polycarbonate Window

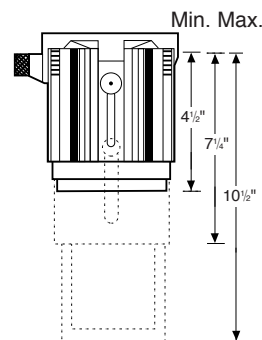

Dimensions of Part No. DZS-001

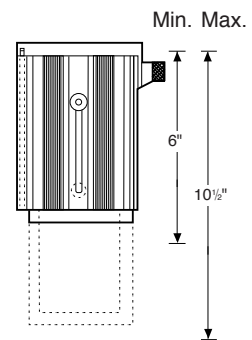

Dimensions of Part No. DZS-005



We recommend a Sensing-Saf-Start[®] or disconnect switch for all power-driven machines—see pages 64-69.

TELESCOPING DRILL PRESS SHIELDS

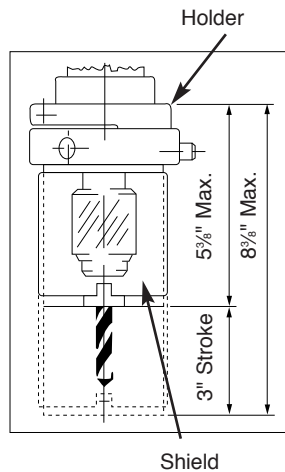

The Construction

The shield consists of two or three chrome-plated steel sleeves. The inner sleeve is a ribbed cage which is held stationary in the shield holder. The outer sleeves are free to move up and down on the inner cage. The inner sleeve has a guide groove, which gives radial movement to the outer sleeves to prevent jamming as the drill descends.

The lower sleeve is fitted with an acrylic transparent window held in position by a locking screw. The window can be slid out and quickly replaced at regular intervals, giving maximum visibility at all times. This sleeve rests on the components to be drilled; as the drilling operation takes place, the cage moves down. This helps protect the window and break up the chips.

When changing a drill bit, the shield can be removed from the shield holder. This gives you access to fit the key into the chuck.

The basic drill press shield (without bushing) is bored to fit a circular quill diameter between $2\frac{5}{8}$ " and $2\frac{3}{4}$ ".

Ordering Information

Part No. DXS-500 Drill Press Shield With Standard Bore $2\frac{3}{4}$ ", **2-Tier**, 3" Stroke; Maximum Chuck Diameter Is $2\frac{5}{8}$ " Without Bushing

Part No. DXS-100 Replacement Polycarbonate Window

Part No. DXS-700 Drill Press Shield With Standard Bore $2\frac{3}{4}$ ", **3-Tier**, 3" or 6" Stroke; Maximum Chuck Diameter Is $2\frac{5}{8}$ " Without Bushing (Similar to 3-Tier Shown on Page 21.)

Part No. DXS-100 Replacement Polycarbonate Window

The Drill Press Shield With All-Around Protection

This durable shield offers all-around operator protection. It provides visibility of the component being drilled without adversely affecting the operation.

The shield holder is bored to a standard size of $2\frac{3}{4}$ " diameter. By using one of ten bushings, the shield holder can be attached to most drilling machine quill diameters without special boring. It is available as an "off-the-shelf" shield assembly.

The drill press shield consists of two major components—the drill press shield holder which is clamped to the quill of the machine, and the drill shield itself. The drill press shield clips into the holder and is held in position by three spring-loaded ball catches. The shield can, therefore, be completely removed from the holder for chuck or drill bit changes.

Bushings

The ten different bushings will cover a round quill diameter down to a minimum of 2". Determine your quill diameter at the time of order and select the appropriate drill press shield and bushing. Please refer to the bushing chart below. Bushings are furnished separately.



The drill press shield can be bushed to accommodate quill diameters between 2" and $2\frac{5}{8}$ ".

Ordering Information

Part Number	Quill Diameter	
	Inches	Millimeters
Std.—No Bushing Needed	$2\frac{3}{4}$ — $2\frac{5}{8}$ to $2\frac{3}{4}$	66.70 to 69.85
DXS-010	$2\frac{5}{8}$ — $2\frac{9}{16}$ to $2\frac{5}{8}$	65.10 to 66.68
DXS-015	$2\frac{9}{16}$ — $2\frac{1}{2}$ to $2\frac{9}{16}$	63.53 to 65.08
DXS-020	$2\frac{1}{2}$ — $2\frac{7}{16}$ to $2\frac{1}{2}$	61.93 to 63.50
DXS-025	$2\frac{7}{16}$ — $2\frac{3}{8}$ to $2\frac{7}{16}$	60.35 to 61.90
DXS-030	$2\frac{3}{8}$ — $2\frac{5}{16}$ to $2\frac{3}{8}$	58.75 to 60.33
DXS-035	$2\frac{5}{16}$ — $2\frac{1}{4}$ to $2\frac{5}{16}$	57.18 to 58.73
DXS-040	$2\frac{1}{4}$ — $2\frac{3}{16}$ to $2\frac{1}{4}$	55.58 to 57.15
DXS-045	$2\frac{3}{16}$ — $2\frac{1}{8}$ to $2\frac{3}{16}$	54.00 to 55.55
DXS-050	$2\frac{1}{8}$ — $2\frac{1}{16}$ to $2\frac{1}{8}$	52.40 to 53.98
DXS-055	$2\frac{1}{16}$ —2 to $2\frac{1}{16}$	50.80 to 52.38

(Continued on next page.)

TELESCOPING DRILL PRESS SHIELDS (continued)

2-Tier Drill Press Shield for Irregular-Shaped Quills

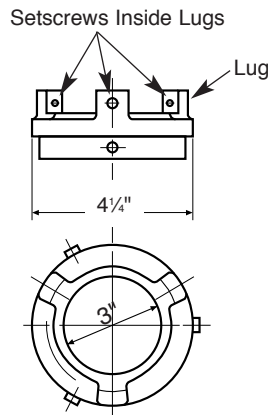

Standard bore 3"; customer can bore up to 3 3/4".

When the quill of a drill press is not round, but an irregular shape (pear shape in some cases), the three-lug drill press shield is ideal. The photo illustrates how the three-lug shield is applied.

This drill press shield is for drill presses that have 3" to 3 3/4" quills. It has three-lug mounting and fits drill presses with a 3" stroke and a maximum chuck diameter of 2 5/8".

If the drill press shields offered in this catalog will not mount to your machine, please send us a photo and dimensions of the quill size. We would be pleased to send you a proposal on a special quill holder.

Ordering Information

Part No. DXS-600 2-Tier Drill Press Shield, 3" Stroke

Part No. DXS-100 Replacement Polycarbonate Window

3-Tier Drill Press Shield for Irregular-Shaped Quills

This drill press shield has the same three-lug mounting as illustrated above. It has a 3" bore and will fit a maximum chuck diameter of 2 5/8". This shield allows 3" or 6" travel of the chuck and drill bit.

When the 3-tier drill press shield is in the position shown here, it has an overall length of 11 1/2". When the thumbscrew is adjusted to the middle or top holes, the overall length is 10" and 8 1/2" respectively. When the thumbscrew is in a retracted position (not in the bottom hole of top tier), the bottom two tiers will move up and down to provide 6" of travel. When the thumbscrew is engaged into one of the three holes, only the bottom tier will travel allowing a 3" stroke.



Ordering Information

Part No. DXS-800 3-Tier Drill Press Shield, 3" or 6" Stroke

Part No. DXS-100 Replacement Polycarbonate Window

SPRING-LOADED/SELF-EJECTING CHUCK KEYS FOR DRILL PRESSES

Ordering Information

Part No.	For LFA® Chuck Model No.	For Jacobs Chuck Model No.	Pilot Size
SLK-001	N/A	0, 0B	1/8"
SLK-002	81-1A, 81-1B	1A, 1B, 1BS, MC1	5/32"
SLK-003	81-4B	7, 7-1A, 7B	7/32"
SLK-004	81b-13A, 81b-13B, 42-13B, 81bS-13A	30, 30-1A, 30B, 31B, 31BA, 81/2N, MC4	15/64"
SLK-005	82-2A, 82-2B	2A, 2B, MC5	1/4"
SLK-006	82A-5A, 43b-5A, 82A-5B, 43b-5B, 82AS-5A, 43BZ-5B	11N, 32, 32B, 33, 33B, 33BA, 33F, 33KD, 3326A, MC-10, MC33	1/4"
SLK-007	4200-B1, 412-B1, 420-B1	DC1G61, DC1G61AD, DC4G61, DC4G61AD, H1G61, MC2, MC1G41, MC1G60, MC1G61, MC1G75, U4G41, U4G60, U4G61	1/4"
SLK-008	422-B13, 4220-B13	DC8K33, DC8K61, DK8K64, H8K33, H8K61, H8K64, MC4K01, MC4K41, MC4K61, MC8K26, MC8K64, MC8K64AD, U8K33, U8K33A, U8K64, U8K64A, U8K61	9/32"
SLK-009	43-6A, 43-6B, 84-6A, 45-6A, 84-6B, 45-6B, 83S-6A, 84S-6A, 44Z-6B, 43SB-6A	3, 3A, 3AE, 3B, 3KD, 3PD, 6AE, 6A-2A, 6A-33, 6B, 14N, 34, 34B, 34KD, 34PD, 55B, 56B, 58B, 75A, 634, 634B	5/16"
SLK-010	85-9A, 85B-9A, 85S-9A, 85BS-9A	16N, 18BN, 36, 36B, 37KD, 37PD, 59B	3/8"
SLK-011	N/A	20N	7/16"

